

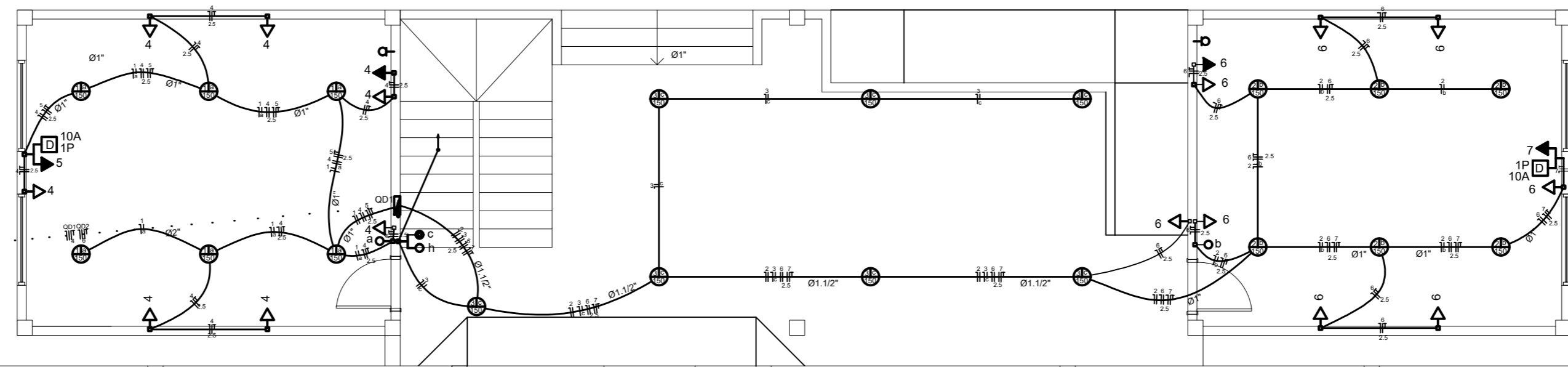







PROJETO ELÉTRICO - Térreo
ESC.: 1/75

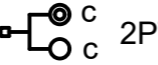
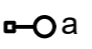

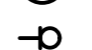
PROJETO ELÉTRICO - 1º Pavimento
ESC.: 1/75

Legenda

-  Caixa de medição embutir a 1,60m do piso
-  10A 1P 7 Conjunto tomada 2PT & disjuntor bipolar a 2,20m do piso
-  2PT Interruptor 1 simples e 1 paralelo - 1,10m do piso
-  a Interruptor simples - 1 tecla a 1,10m do piso
-  Luminária p/ lâmpada incand. comum- teto
-  b Ponto de TV a 0,30m do piso
-  Quadro de distribuição - sobrepor a 1,50m do piso
-  4 Tomada hexagonal (NBR 14136) - 2P+T 10 A a 0,30m do piso
-  4 Tomada hexagonal (NBR 14136) - 2P+T 10 A a 2,20m do piso

Departamento de Engenharia & Arquitetura

Fone: (51)3653-1266 (225) e-mail: planejamento@taquari-rs.com.br

Obra: Ampliação Escola Emilio Schenk

Data:
Fevereiro/ 2019

Descrição: Projeto Elétrico Térreo e 1º Pav.

Escala:
1/75

Endereço da obra: RUA OSVALDO MICHEL - LÉO ALVIM FALLER

Responsável técnico:
Sérgio Vinicius Noschang CREA RS 152282

Projetista: _____ Área: 273,40 m²

Prancha:
ELET
01-01